

JS700P ProJuicer 600W

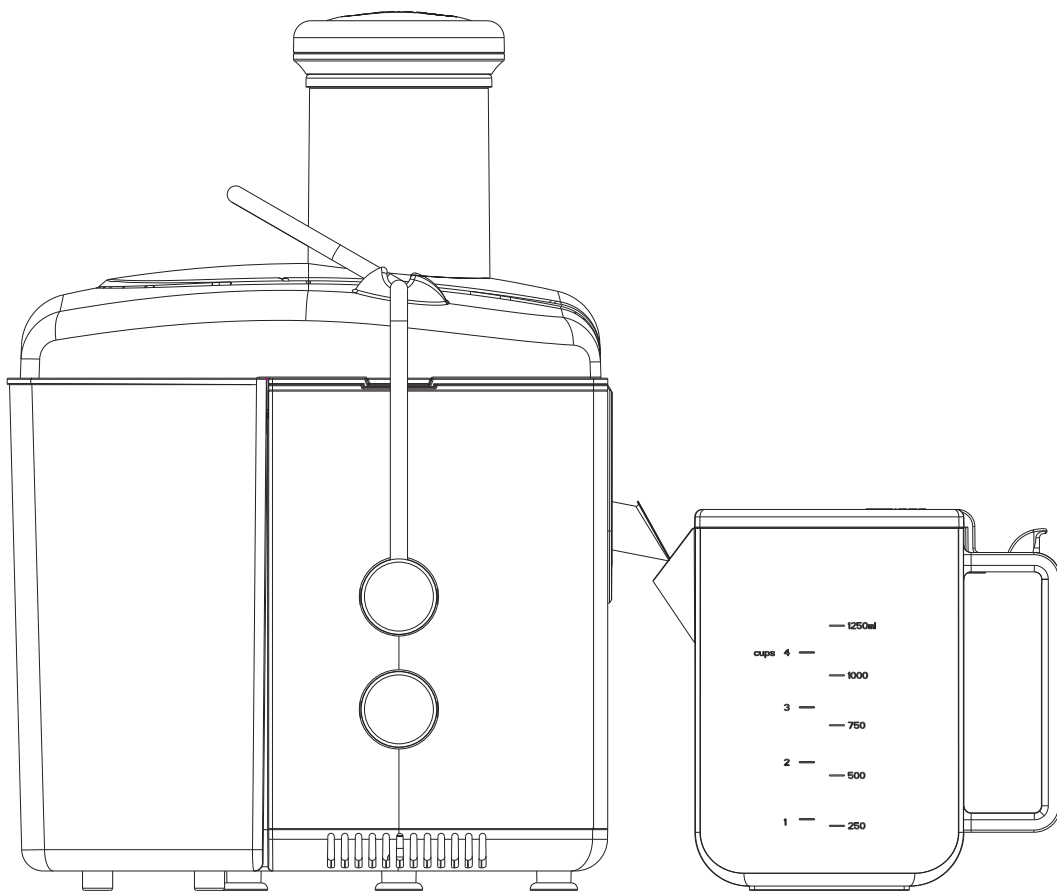

Made in China



INSTRUCTION MANUAL

Caution: Read and follow all safety and operating instruction before first use of this product.

Campomatic S.R.L. Via Configliachi 5/B . 35031, Abano Terme (Padova), ITALIA

WWW.CAMPOMATIC.COM

Identification of parts



Important safety notes



How to use



Cleaning and caring



Trouble shooting



Technical specifications





Identification of parts

- 1- Pusher
- 2- Lid
- 3- Filter
- 4- Juice collector
- 5- Pulp container
- 6- Spout
- 7- Handle
- 8- Motor base
- 9- Foam separator
- 10- Jug lid
- 11- Juice jug

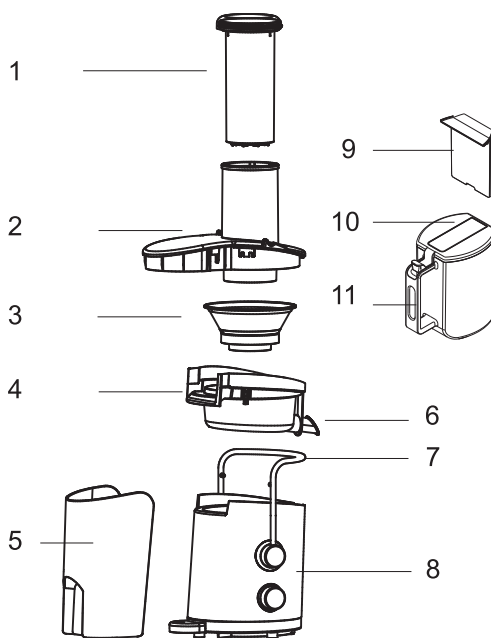



IMPORTANT SAFETY NOTES

1. This appliance is intended for household use only.
2. Read all instructions before use, and see all diagrams, and keep these instructions for further reference.
3. Don't operate the appliance for more than 60 seconds at a time when blending heavy loads and let it cool down sufficiently afterwards.
4. Check if the voltage indicated on the base of the appliance corresponds to the local mains voltage before you connect the appliance.
5. Don't let cord hang over edge of table or counter, do not let cord contact hot surface, including the stove.
6. Never use accessories or parts made by other manufactures not recommended or sold; may cause a risk of injury to persons.
7. Do not use the appliance if it's power cord, plug, blade device or other part is damaged . In the event of any damage to the power cord or blade device of this product, it can only be replaced with a special one for use with this product or special servicing agency.
8. Do not place hands in the jar while the appliance is operating.
9. Do not remove the jar or grinding cup from the base when the appliance is in operation.
10. Make sure all parts are correctly mounted before you switch on the appliance.
11. The appliance is not intended for use by young children or infirm persons without supervision.
12. Make sure the motor and blade have completely stopped before dis-assembling and cleaning.
13. Avoid touching the sharp blades, especially when the appliance is plugged in.
14. Don't immerse the motor base, plug or cord in water or any other liquid.

*** Please follow the above safety precautions**



HOW TO USE

Preparing for use:

1. Wash all detachable parts (see chapter cleaning)
2. Set the control knob to position “0” to switch the appliance off.
3. Be sure all parts are properly assembled and in place before use.

Using the juicer:

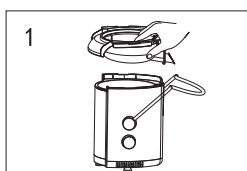

1. Place the juice collector into the appliance.

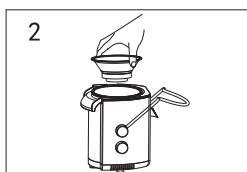

2. Put the filter in the juice collector, make sure the filter is fitted securely onto the clutch ("click") Always check the filter before use, if you detect any cracks or damage do not use the appliance and contact the nearest appliance center or take the appliance to your dealer.

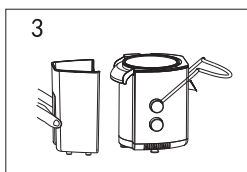

3. Place the pulp container into the appliance by tilting it forwards slightly. Insert the top and first and then push home the bottom end. While you are preparing juice, you can empty the pulp container by switching the appliance off and carefully removing the pulp container. Reassemble the empty pulp container before you continue juicing.

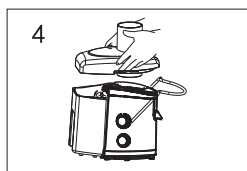

4. Hold the lid over the filter and lower it into position, snap the handle onto the lid to lock it into place ("click"). Make sure the handle is locked into position on either side of the lid.

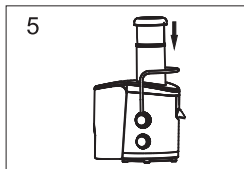

5 . Slide the pusher into the feeding tube by aligning the groove in the pusher with the small protrusion on the inside of the feeding tube.

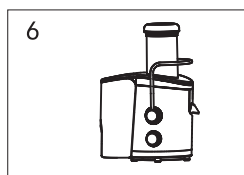

6. Place the juice jug under the spout. Place the lid on the juice jug to avoid splattering or if you want to store the juice in the refrigerator.

7. To separate the foam from the juice when pouring the juice into a glass, insert the foam separator by sliding it into the juice jug .

Attention: If you want your drink to have a foamy layer, do not use the foam separator!

8. The appliance will only function if all parts have been properly assembled and the lid has been properly locked in place with the handle .
---Wash the fruit /vegetables well and cut them into picecs that fit into the feeding tube without forcing.

---Make sure the juice jug has been placed under spout.

9. Plug cord plug into the power socket, switch the appliance on by turning the control knob to setting " I "(lower speed) or " II "(normal speed).

---Speed I is especially suitable for soft fruits and vegetables. Such as watermelons, grapes, tomatoes, cucumbers and raspberries.

---Speed II is suitable for all kinds of fruits and vegetables.

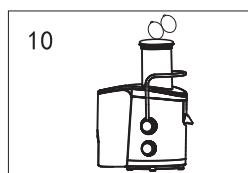

10. Put the pre-cut pieces in the feeding tube .

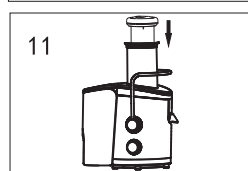

11. Gently press them down towards the rotating filter by means of the pusher.

Notice :do not exert too much pressure on the pusher, as this could affect the quality of the end result and it could even cause the filter to come to a halt, never insert your fingers or an object into feeding.

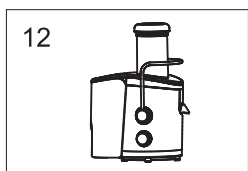

12. After you have processed all ingredients and the juice flow has stopped, switch the appliance off and wait till the filter has stopped rotating.

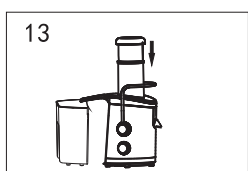

13. If the motor base starts to vibrate violently and produce less juice, switch it off, then remove and clean the filter.



TIP FOR USE:

1. Use only good quality, fruit and vegetables, preferably fresh vegetables and ripe fruits, as they contain more juice.
2. Pineapples, beetroots, celery stalks, cucumbers, carrots, spinach, melons, tomatoes, pomegranates, oranges and grapes are particularly suitable for processing in the juicer extractor.
3. To extract the maximum amount of juice, always press the pusher down slowly.
4. The juicer is not suitable for processing very hard and/or fibrous/starchy fruits or vegetables such as sugar cane.
5. Apple juice may turn brown quickly. A few drop of lemon juice will slow down the process.
6. Fruits that contain starch, such as bananas, papayer, avocados, figs and mangoes are not suitable for processing in the juice extractor, use a food processor, blender or bar blender to process these fruits.
7. Drink the juice immediately after you have extracted it, if it is exposed to air for some time, the juice will lose its taste and nutritional value.



CLEANING AND CARING

The appliance is easier to clean if you do so immediately after use.

1. Switch the appliance off, remove the plug from the wall socket and wait until the filter has stopped rotating.
2. Remove the dirty parts from the motor unit.
 - Remove the pusher.
 - open the handle.
 - Remove the lid.
 - Remove the pulp container.
 - Remove the juice collector together with the



3. Clean these parts with the cleaning brush in warm water with some washing-up liquid and rinse them under the tap.

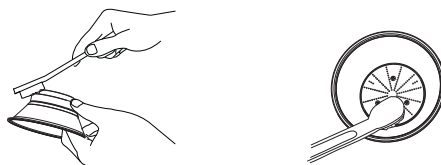

4. Clean the motor base with a damp cloth, never immerse the motor base in water nor rinse it under the tap caring.
5. Avoid touching the sharp blades, especially when the appliance is plugged in.

Caring:

1. Please store the appliance on dry environment.
2. Never put the filter, or any other parts, in a microwave oven.
3. Never store foods or drinks in the jug.



TROUBLE SHOOTING

- 1.If, during use, the product is subjected to such abnormality as noise, smell, smog and increased temperature, disconnect the power supply and stop the use.
- 2.In case the appliance fails to work, please check whether the power supply is properly connected, whether the switch is rotated to the on position and whether the fittings are in place.
- 3.If the appliance can not still function well after the above in spections, consult the designated servicing agency.