

CAMPOMATIC

SFI 4DR SLIM DIGITAL FAN

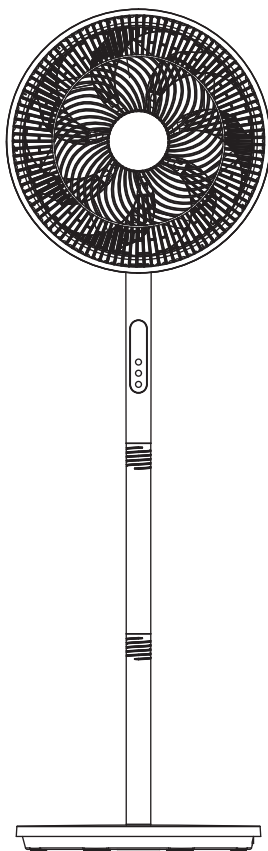

Made in China



INSTRUCTION MANUAL

Caution: Read and follow all safety and operating instruction before first use of this product.

Campomatic S.R.L. Via Configliachi 5/B . 35031, Abano Terme (Padova), ITALIA
WWW.CAMPOMATIC.COM

IMPORTANT SAFETY INSTRUCTIONS

CAUTION

1. Read Rules for Safe Operation and Instructions Carefully.
2. This appliance can be used by children aged from 8 years and above and persons with reduced physical, sensory or mental capabilities or lack of experience and knowledge if they have been given supervision or instruction concerning use of the appliance in a safe way and understand the hazards involved. Children shall not play with the appliance. Cleaning and user maintenance shall not be made by children without supervision.
3. Never insert fingers, pencils, or any other object through the grille when fan is running.
4. Disconnect fan when moving from one location to another.
5. Be sure fan is on a stable surface when operating to avoid overturning.
6. DO NOT use fan in window, rain may create electrical hazard.
7. This appliance is for household use only.

WARNING

1. If the supply cord is damaged, it must be replaced by manufacturer or its service agent or a similarly qualified person in order to avoid a hazard.
2. To protect against the risk of electrical shock, do not immerse the unit, cord or plug in water or other liquid.
3. When the appliance is not in use and before cleaning, unplug the appliance from the outlet.
4. When the fan was assembled, the rotor blade guard shall not be taken off anymore.
 - Prior cleaning unplug the fan.
 - The rotor guard shall not be disassembled/opened to clean the rotor blades.
 - Wipe the fan enclosure and rotor blade guard with a slightly damp cloth.

SAVE THESE INSTRUCTIONS

PRODUCT INTRODUCTION

Notice:

All the pictures in this manual are for explanation purposes only. Any discrepancy between the real object and the illustration in the drawing shall be subject to the real model.

Name of components

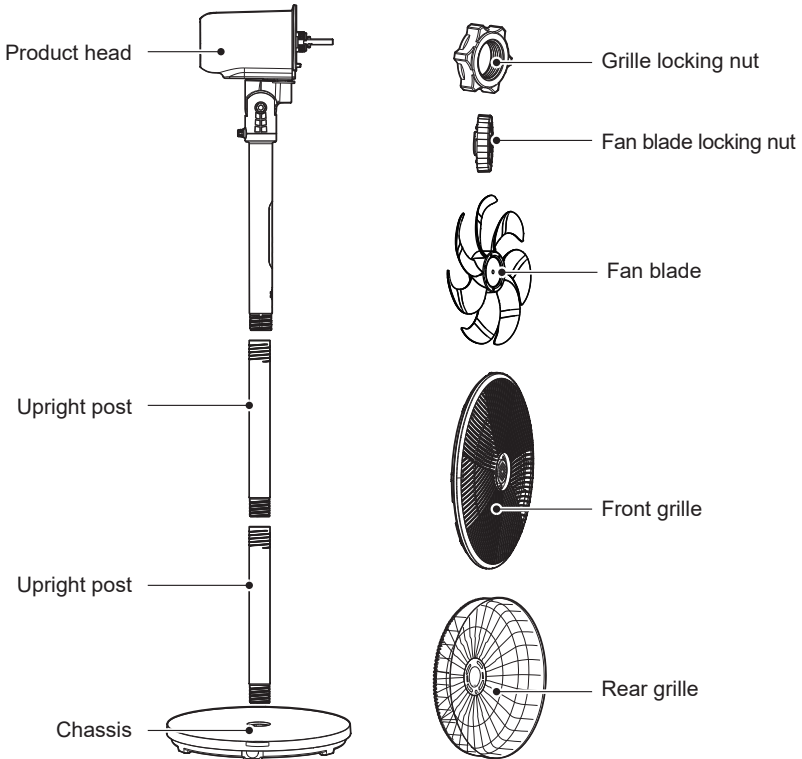

Accessories

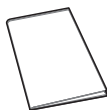

Instruction manual x1



Remote control x1

INSTALLATION INSTRUCTIONS

Column and Head Installation

First, align the ③ column with the ④ base chassis connector and tighten clockwise. Then align the ② column with the ③ column connector and tighten clockwise. Finally, align the ① head fixing column with the ② column connector and insert it, tightening clockwise to secure.

Fig.1

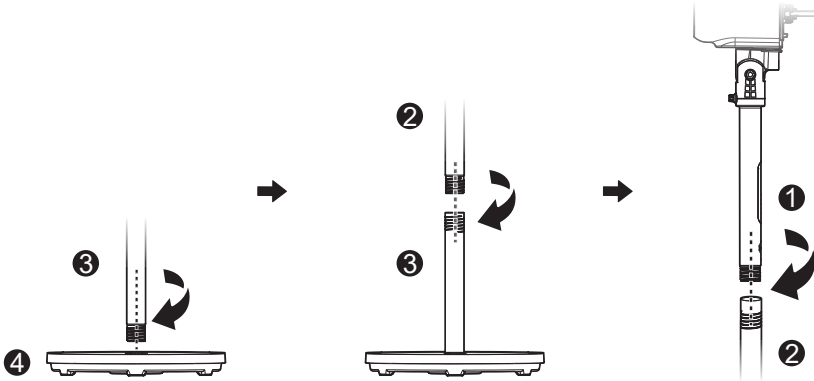

Rear Grille Installation

First, remove the ⑤ grille locking nut and ⑥ fan blade locking nut from the motor shaft.

Fig.2

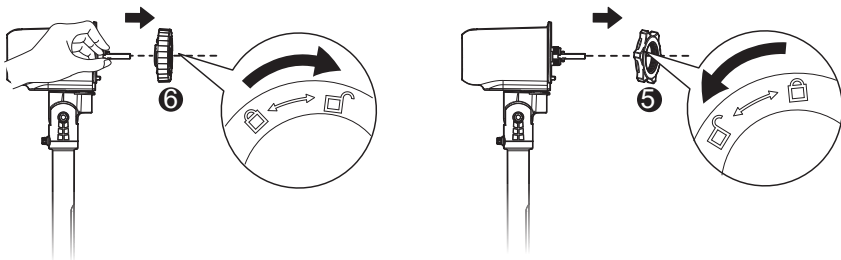

Step 1
Operation key point: Hold the motor shaft with your hand, then loosen the fan blade locking nut clockwise.

Step 2
Loosen the grille locking nut counterclockwise.

INSTALLATION INSTRUCTIONS

Hang the **9** rear grille onto the motor's front shell; rotate the **5** grille locking nut clockwise to secure the **9** rear grille.

Fig.3

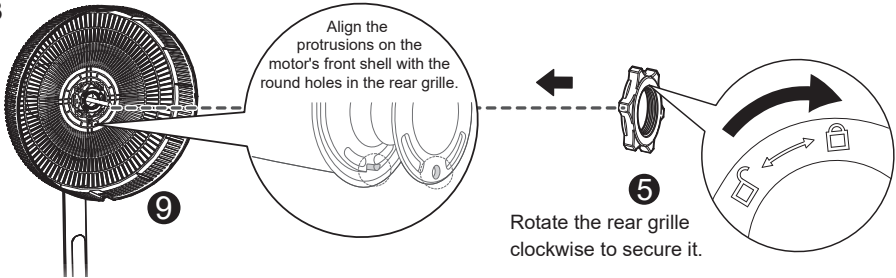

Misalignment will result in an insecure installation and incorrect logo on the front grille.

Fan Blade Installation

Use the **6** fan blade locking nut to secure the **7** fan blade onto the motor shaft.

Fig.4

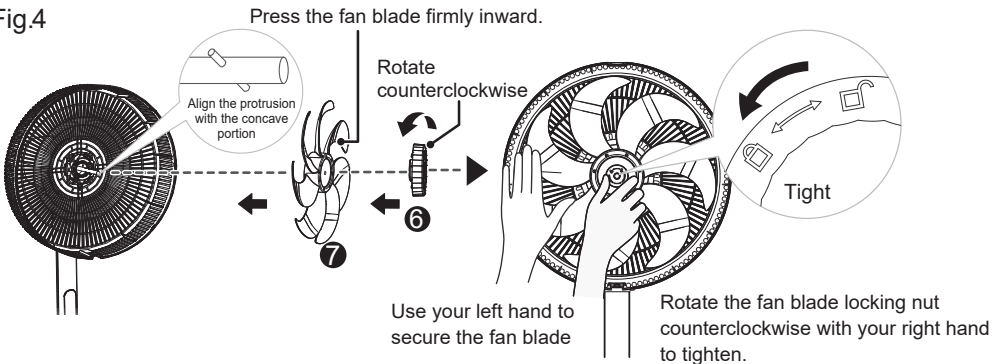

Front Grille Installation

Fig.5

Step 1

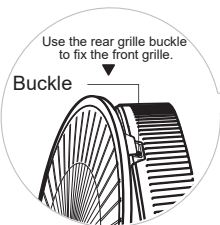

Step 2 Press the grille with both hands in sequence until you hear a "click" sound, indicating it is securely installed.

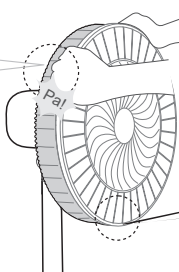

Remove the screws from the grille buckle.

Step 4

Snap the grille buckle in place and secure with the screws.

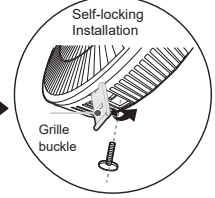
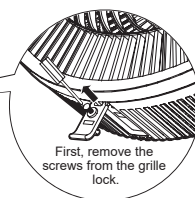



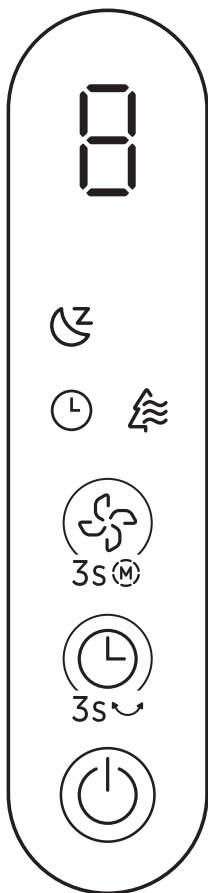

USE INSTRUCTION



Operating instructions of the machine body



Display Area

Icon	Function Description
	Natural Wind mode indicator When the device is powered on, if the Natural wind mode is enabled, this indicator lights up; otherwise, it will be off.
	Sleep Wind mode indicator When the device is powered on, this indicator lights up if the sleep mode is enabled; otherwise, it turns off.
	Timer indicator When the device is powered on, this icon lights up if the device is in the timer setting screen or the scheduled power-off function is enabled; otherwise, it turns off.
	Digital Tube <ul style="list-style-type: none"> In power-on mode, when the scheduled power-off timer is set, this digital tube flashes to display the scheduled power-off time. In power-on mode, when the fan speed level is set, this digital tube displays the set fan speed level.

Operating Button

Button	Function Description
	On/Off button In the power-off state, short press the button to power on the device; in the power-on state, short press the button to power off the device.
	Timing button <ul style="list-style-type: none"> In the power-on state, short press this button to set the timer. In the power-on state, press and hold this button for 3 seconds to turn the left-right oscillation on or off.
	Wind Speed button <ul style="list-style-type: none"> In power-on mode, short press this button to cycle through the corresponding fan speed levels and adjust the fan speed. In power-on mode, long press for 3 seconds to set the fan mode, cycling through Normal -> Sleep -> Natural -> Normal.

CAUTION

If there is no operation during the operation of the machine, it will automatically shut down after 24 hours of continuous operation.

OPERATING INSTRUCTION





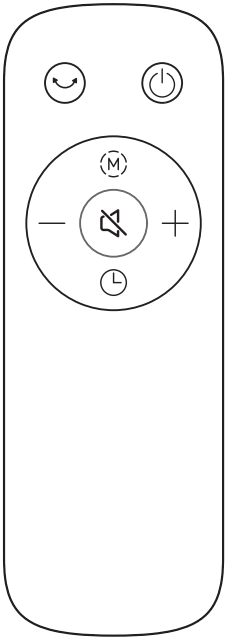

Remote Controller

Point the remote controller at the receptor on body of the fan and press the desired button.

The remote controller will work at distances of up to roughly 5 meters and the angle of 30 degree included between right and left from the receptor.

The batteries must be removed from the remote controller before it is scrapped and that they are disposed of safely.



Button	Function Description
	Power Button <ul style="list-style-type: none"> In the power-off state, short press to enter the power-on state. In the power-on state, short press this button to power off.
	Oscillation (left-right swing) button <ul style="list-style-type: none"> Short press this button to oscillate the left and right oscillation.
	Wind Mode Button <ul style="list-style-type: none"> Short-press the button to cycle through wind modes: Normal Wind → Sleep Wind → Natural Wind → Normal Wind...
	Increase + / Decrease - button <ul style="list-style-type: none"> Use the + button to increase the wind speed. Use the - button to decrease the wind speed. In the timer setting screen, press the + button to increase the timer (0-1...9-0 cyclic setting). In the timer setting screen, press the - button to decrease the timer (0-9...1-0 cycle setting).
	Mute button <ul style="list-style-type: none"> Short press to turn the buzzer on or off.
	Timing button <ul style="list-style-type: none"> In the timer setting interface, press the timer button to adjust the timer (set in a cycle from 0-1...9-0).

OPERATING INSTRUCTION

Battery Installation

1. Slide the battery compartment cover.
2. Insert the batteries, and make sure that the batteries are placed as shown in the Figure 6.
3. Slide back the battery cover.

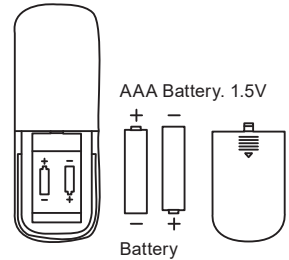
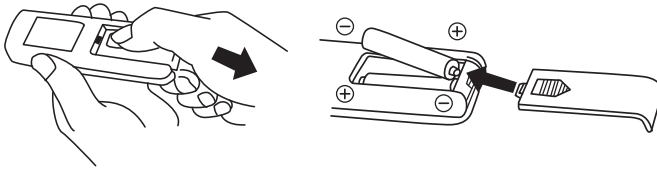

Fig.6

Note:

- Do not dispose of batteries in fire, batteries may explode or leak.
- Do not mix old and new batteries.
- Do not mix alkaline, standard (carbon-zinc) or rechargeable (nickel-cadmium) batteries.
- Pay attention to poles (+ and -) of the batteries.
- Non-rechargeable batteries are not to be recharged.
- Rechargeable batteries are to be removed from the appliance before being charged.
- If the appliance is to be stored unused for a long period, the batteries should be removed.
- The supply terminals are not to be short-circuited.

DISPOSAL AND RECYCLING

The appliance must not be disposed of with regular household waste. At the end of its service life, the appliance must be properly delivered to a collection point for the recycling of electrical and electronic equipment. By Collection and recycling of old appliances, you are making an important contribution to the conservation of our natural resources and provide for environmentally sound and healthy disposal.

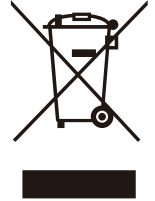

PRODUCT PARAMETERS

Model	Voltage	Frequency	Power
SF14DR	220-240V~	50/60Hz	40W

